

PROPERTY OF

PPI IS NOT RESPONSIBLE FOR PRODUCT COMPATABILITY.
NOT ALL MATERIALS ARE SUITABLE FOR ALL APPLICATIONS.



PARKWAY PLASTICS

IT IS THE BUYER'S SOLE RESPONSIBILITY TO TEST THE COMPATIBILITY
OF THEIR PRODUCTS WITH PARKWAY'S PRODUCTS & SERVICES.

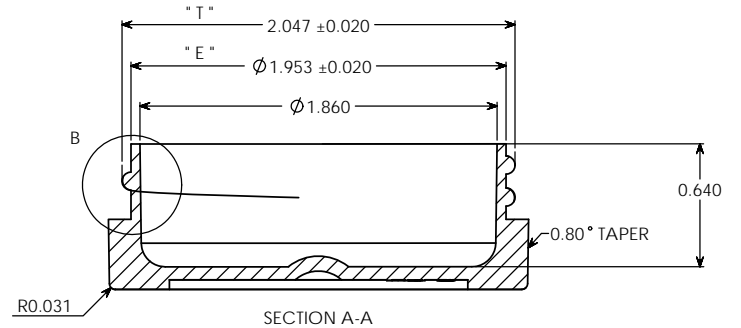
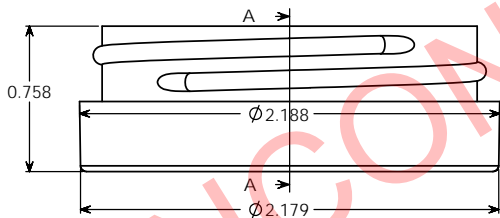
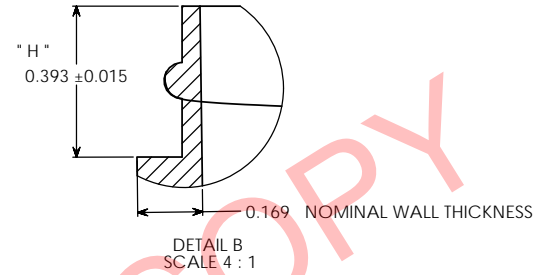
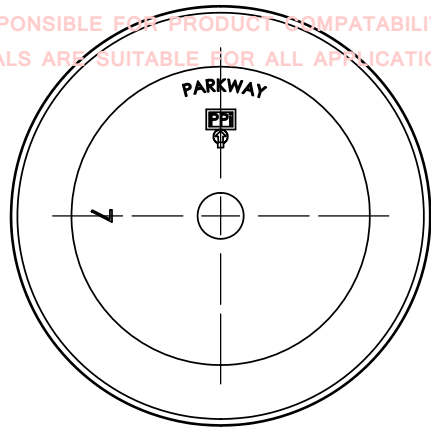

NOTE

Manufacturer reserves the right to change specifications without notice. All purchase order for the item herein described, must be accompanied by a copy of this print. All dimensions have a tolerance of +/- 3 % unless otherwise specified.
SIDEWALL CAMBER .050" PER SIDE MAX.
THREAD = GCM1 400- CT FINISH
6 THREADS PER INCH.

OVERFLOW: 27 ML
WEIGHT: 13 GRAMS ± 2 GRAMS

UNCONTROLLED COPY

<p>PROPRIETARY AND CONFIDENTIAL THE INFORMATION CONTAINED IN THIS DRAWING IS THE SOLE PROPERTY OF PARKWAY PLASTICS INC. ANY REPRODUCTION IN PART OR AS A WHOLE WITHOUT THE WRITTEN PERMISSION OF PARKWAY PLASTICS INC IS PROHIBITED.</p>		<p>NAME: G.W.W DATE: 01/10/13</p>	<p>PARKWAY PLASTICS INC</p>
<p>* T * DIMENSION: 2.047 ± 0.020</p>	<p>UNLESS OTHERWISE SPECIFIED: DIMENSIONS ARE IN INCHES TOLERANCES: FRACTIONAL ± ANGULAR: MACH ± BEND ± TWO PLACE DECIMAL * THREE PLACE DECIMAL *</p>	<p>DRAWN: G.W.W CHECKED: ENG APPR:</p>	<p>TITLE: 1/2 OZ 53 MM THICK WALL STYRENE JAR (CUSTOMER PRINT)</p>
<p>* E * DIMENSION: 1.953 ± 0.020</p>		<p>DIA: COMMENTS:</p>	<p>SIZE: DWG. NO. REV C B0530050CSC</p>
<p>* H * DIMENSION: 0.393 ± 0.015</p>	<p>MATERIAL: U11 COLOR: NA DECORATION: NA</p>	<p>REPLACES PRINT #HOSTWJ</p>	<p>SCALE: 2:1 WEIGHT: SHEET 1 OF 1</p>
<p>SECTION VIEW A - A: JAR</p>	<p>DETAIL VIEW B: * H * DIMENSION</p>	<p>APPLICATION: DO NOT SCALE DRAWING</p>	