

**PROPERTY OF**

PPI IS NOT RESPONSIBLE FOR PRODUCT COMPATABILITY.  
NOT ALL MATERIALS ARE SUITABLE FOR ALL APPLICATIONS.



**PARKWAY PLASTICS**

IT IS THE BUYER'S SOLE RESPONSIBILITY TO TEST THE COMPATIBILITY OF  
THEIR PRODUCTS WITH PARKWAY'S PRODUCTS & SERVICES.

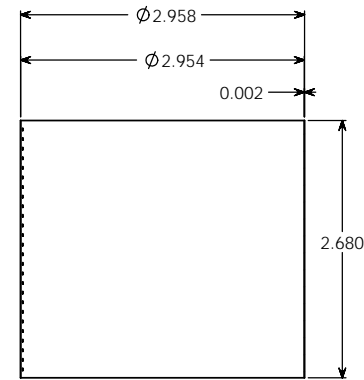
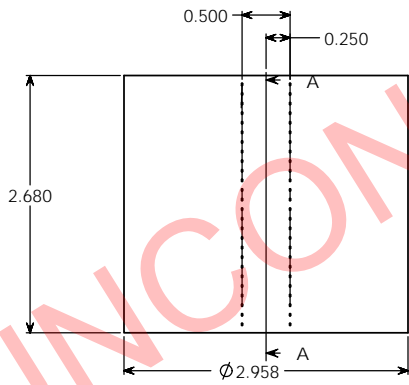
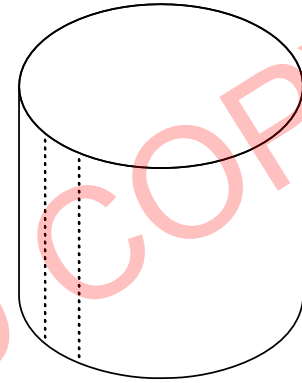
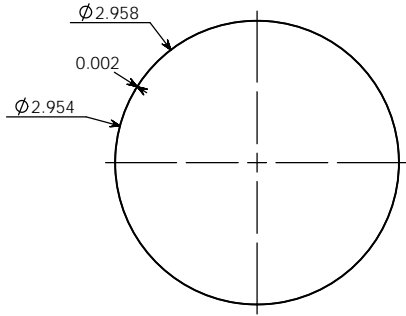

SECTION A-A

**NOTE:**

SHRINKSLEEVES ARE SHIPPED  
PRESSED FLAT WITH SPECIFIC WIDTH  
& HEIGHT MEASUREMENTS. EACH  
MEASUREMENT HAS A TOLERANCE  
OF +/- .125 INCHES (3.175 MM).

UNCONTROLLED COPY

**PROPRIETARY AND CONFIDENTIAL**  
THE INFORMATION CONTAINED IN THIS  
DRAWING IS THE SOLE PROPERTY OF  
PARKWAY PLASTICS INC. ANY  
REPRODUCTION IN PART OR AS A WHOLE  
WITHOUT THE WRITTEN PERMISSION OF  
PARKWAY PLASTICS INC IS PROHIBITED.

<b>WIDTH</b>	<b>HEIGHT</b>	<b>UNLESS OTHERWISE SPECIFIED:</b>	<b>NAME</b>	<b>DATE</b>	<b>PARKWAY PLASTICS INC</b>
118MM	68MM	DIMENSIONS ARE IN INCHES TOLERANCES: FRACTIONAL ± ANGULAR MATCH ± BEND ± TWO PLACE DECIMAL ± THREE PLACE DECIMAL ±	S.P.	02/03/15	
		INTERPRET GEOMETRIC TOLERANCING PER:	<b>CHECKED</b>		<b>TITLE:</b>
		MATERIAL	<b>ENG APPR</b>		4OZ 70MM TW CLEAR PVC SHRINK SLEEVE
<b>NEXT ASSY</b>	<b>USED ON</b>	<b>FINISH</b>	<b>MFG APPR</b>		<b>SIZE</b>
			<b>D.A.</b>		<b>C</b>
<b>APPLICATION</b>	<b>DO NOT SCALE DRAWING</b>		<b>COMMENTS:</b>		<b>DWG. NO.</b>
					B0700400 Shrink Sleeve
					<b>REV</b>
					SCALE: 1:1
					<b>WEIGHT:</b>
					<b>SHEET 1 OF 1</b>

## PROPERTY OF

PPI IS NOT RESPONSIBLE FOR PRODUCT COMPATABILITY.  
NOT ALL MATERIALS ARE SUITABLE FOR ALL APPLICATIONS.



## PARKWAY PLASTICS

IT IS THE BUYER'S SOLE RESPONSIBILITY TO TEST THE COMPATIBILITY OF  
THEIR PRODUCTS WITH PARKWAY'S PRODUCTS & SERVICES.

# 4OZ 70MM TW CLEAR PVC SHRINK SLEEVE 118MM X 68MM



UNCONTROLLED COPY