

PARKWAY PLASTICS

PROPERTY OF
PPI IS NOT RESPONSIBLE FOR PRODUCT COMPATIBILITY
NOT ALL MATERIALS ARE SUITABLE FOR ALL APPLICATIONS

IT IS THE BUYER'S SOLE RESPONSIBILITY TO TEST THE COMPATIBILITY
OF THEIR PRODUCTS WITH PARKWAY'S PRODUCTS & SERVICES.

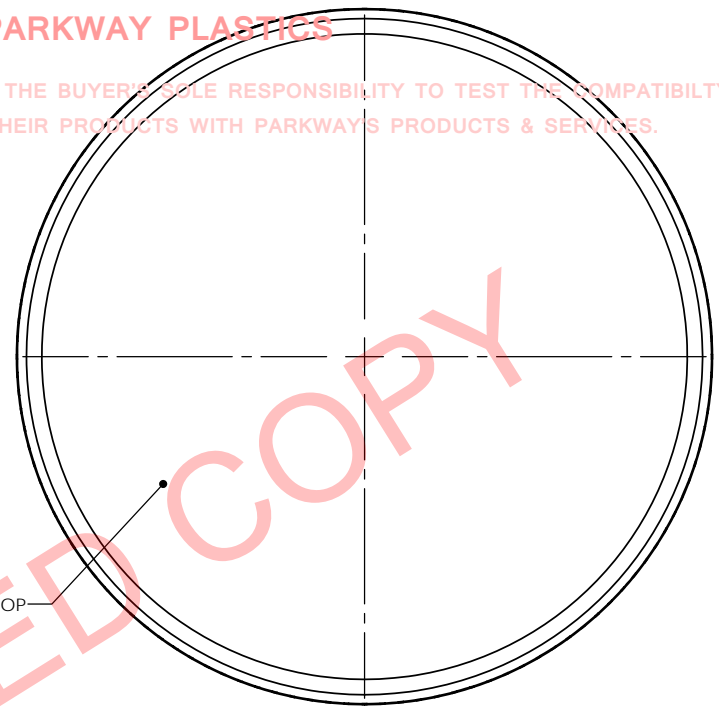

MATTE FINISHED TOP

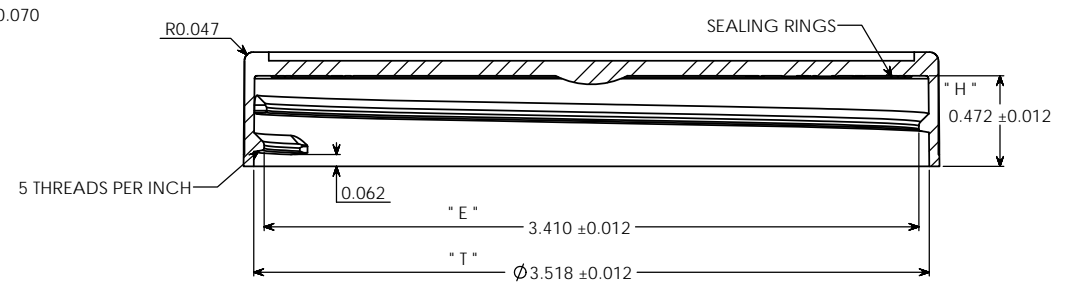
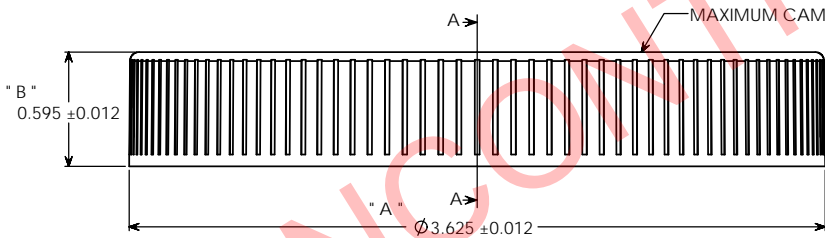

SECTION A-A

NOTE
MANUFACTURER RESERVES RIGHT TO
CHANGE SPECIFICATIONS WITHOUT NOTICE

WEIGHT: 14.80 GRAMS ± 2 GRAMS

<small>PROPRIETARY AND CONFIDENTIAL THE INFORMATION CONTAINED IN THIS DRAWING IS THE SOLE PROPERTY OF PARKWAY PLASTICS INC. ANY REPRODUCTION IN PART OR AS A WHOLE WITHOUT THE WRITTEN PERMISSION OF PARKWAY PLASTICS INC IS PROHIBITED.</small>		<small>DIMENSIONS ARE IN INCHES TOLERANCES: FRACTIONAL ± ANGULAR MATCH ± BEND ± TWO PLACE DECIMAL ± THREE PLACE DECIMAL ±</small>		<small>NAME</small> G.W.W.	<small>DATE</small> 12/05/12	PARKWAY PLASTICS INC TITLE: 89MM RIBBED WALL CAP (CUSTOMER PRINT)	<small>SIZE</small> C	<small>DWG. NO.</small> C089C4RPLIN	<small>REV</small>
<small>SECTION VIEW</small> A - A	<small>CAP</small>	<small>COLORANT</small> NA	<small>MATERIAL</small> S10-01	<small>COMMENTS</small> REPLACES PRINT # 89SCRP			<small>SCALE:</small> 2:1	<small>WEIGHT:</small>	<small>SHEET 1 OF 1</small>